

PROTEUS® K4 Basics

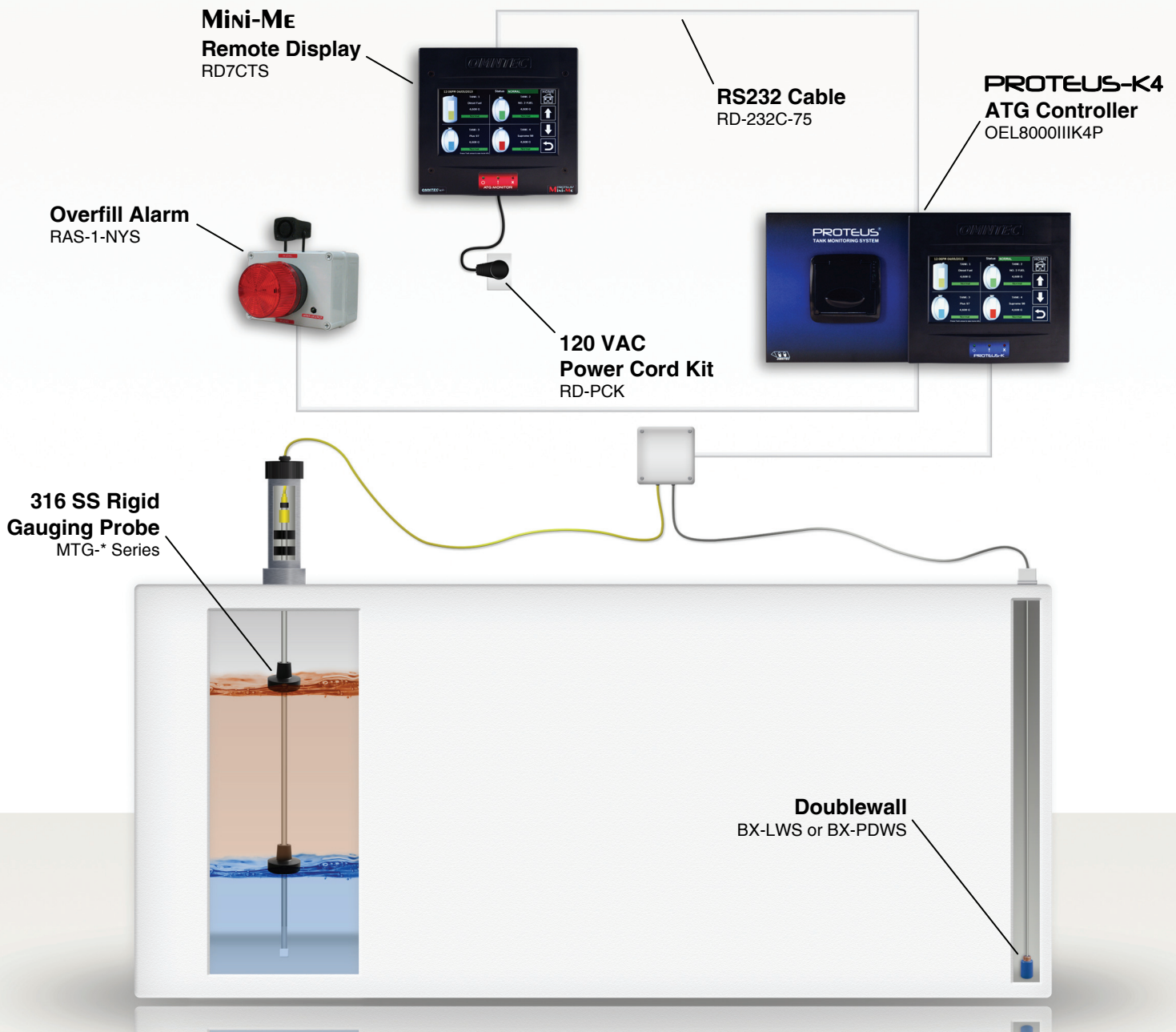

OEL8000IIIK4 System Parts List

| | |
|-----------------------------|--|
| OEL8000IIIK4 | PROTEUS® K4 Tank Gauging Controller with 7" color touch screen, (1) RS-232 port, & Ethernet. Accepts up to 4 MTG Series inventory probes and 16 BX Series leak sensors. |
| OEL8000IIIK4P | (same as above but includes printer) |
| MTG-* | Magnetostrictive probe (*denotes probe length, price for up to 12 ft.). <i>Consult factory for alternate probes sizes and styles.</i> |
| BX-LWS** BX-PDWS** | Sensor for monitoring the dry interstice of double-wall steel tanks. Comes with 25' of cable. **For tanks less than 8' diameter, a BX-LS or BX-PDS can be used. |
| RAS-1-NYS | Common overfill remote annunciator in Nema 4X enclosure, with acknowledgement switch, 100db horn, and high intensity strobe light. |
| Optional Accessories | |
| RD7CTS | PROTEUS® Mini-Me™ universal remote ATG monitor with 7" color touch screen display for audio/visual alarms and current inventory. |
| RD-232C-75 | 75 feet RS232 cable for use with RD7CTS remote display. |
| RD-PCK | 120 VAC power cord kit for use with PROTEUS® remote displays. |
| C232-422-RD7CTS | RS-232-422 Booster Kit to increase distance of RS-232 output 3,000 feet for use with RD7CTS remote display <i>(Includes 2 converters and 2 power transformers).</i> |
| WRS-232 | Wireless RS-232 link includes both tank gauge and remote transceivers up to 500 feet. |
| WRS-232R | Wireless RS-232 repeater for extending WRS-232 wireless reach up to 500 feet. |

OMNTEC®